



**MONDE
DESIGN
CARAVAN**

*A Pioneering Vision in Caravan Design
and Manufacturing*

CATALOG 2024

<https://www.mondecaravan.com/en>



ABOUT MONDE DESIGN



Established in 2019, Turkey, *Monde Design* is a company dedicated to pioneering advancements in caravan design and manufacturing. Our founding team comprises experienced professionals in architecture, industrial production, marketing, and trade, united by a shared passion for nature and environmental consciousness. These core values form the bedrock of the Monde Design brand.

Our design philosophy centers around sustainability, innovation, ergonomic considerations, and aesthetic excellence. We aim to contribute to the caravanning industry by strengthening the bond between humans and nature. We achieve this by utilizing eco-friendly materials and manufacturing techniques, developing modern and functional designs, and promoting the caravanning lifestyle.

Key features of *Monde Design Caravans* include:

- **Sustainability:** Implementation of environmentally friendly technologies such as solar panels
- **Innovation:** Pioneering solutions such as modular furniture, and compact designs.
- **Ergonomics:** Prioritizing user comfort and safety through ergonomic design principles.
- **Aesthetics:** Cultivating an aesthetic sensibility in caravans through modern and stylish designs.

Monde Design Caravan aspires to play a leading role in the caravanning industry and contribute to its overall advancement. Through our commitment to sustainable and innovative design, we strive to redefine the caravanning experience and strengthen the connection between humans and nature.



OUR TRAILER CARAVANS

MONDE DESIGN CARAVANS: EMBARK ON UNFORGETTABLE JOURNEYS

Monde Design Caravans caters to the spirited adventurer with its meticulously crafted collection of compact, minimalist caravans. Each model seamlessly blends elegance, comfort, and safety, ensuring an unparalleled travel experience

UNWAVERING DEDICATION TO QUALITY

Premium Chassis: ALKO and KNOTT brand chassis provide a robust foundation for every caravan.

Durable Construction: The hybrid exterior shell, combining fiberglass and CTP panels, offers enhanced strength and weather resistance. The wall thickness is 35 mm.

Superior Insulation: 32 dns XPS (extruded polystyrene foam) is used as insulation material on the floor, walls, and ceiling.

Customization Options: Personalize your caravan's exterior with an array of color choices.

Uncompromising Functionality: Double-walled plexiglass windows with blackout curtains and mosquito nets deliver exceptional comfort and privacy.

Marine-Grade Interiors: Laminate-coated marine poplar plywood guarantees lasting durability and a sophisticated aesthetic.

SPACIOUS COMFORT WITHIN COMPACT DESIGNS

Despite their streamlined exteriors, each **Monde Design Caravan** boasts a surprisingly spacious and comfortable interior. Diverse models cater to varying needs, offering various accommodation capacities and functional areas, including well-equipped kitchens and bathrooms.

DISCOVER YOUR IDEAL ESCAPE

Monde Design Caravans proudly presents three distinct models;

- **Monde 320,**
- **Monde 375,**
- **Monde 425** guaranteeing the perfect match for your travel aspirations.







MONDE CARAVAN DESIGN: STRATEGIES FOR MAXIMIZING SMALL SPACES

MONDE 320

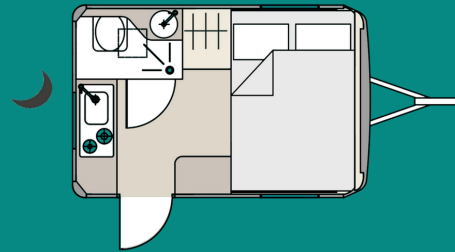
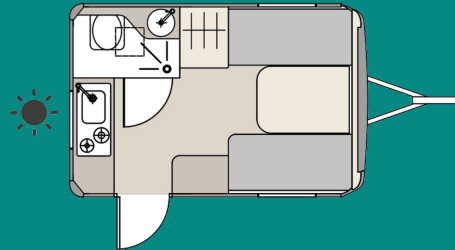

MONDE 375

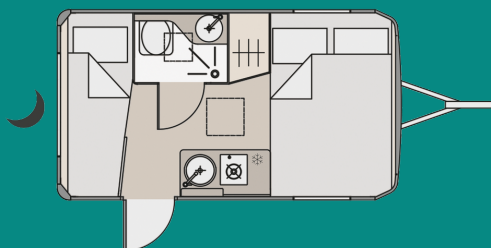
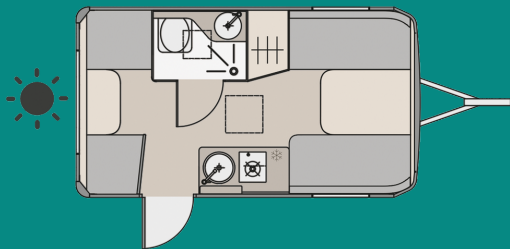

MONDE 425

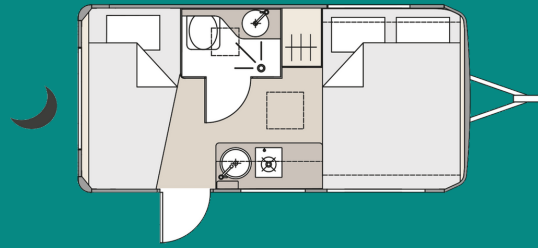
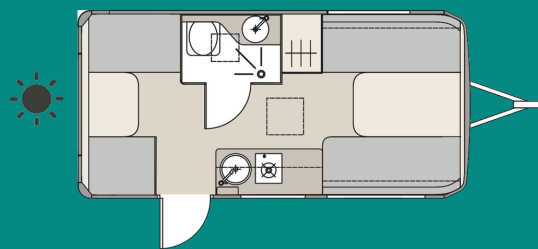

MONDE 320

CARAVAN DIMENSION

- BODY LENGTH: 320 CM (126 INC)
- OVERALL LENGTH: 457 CM (179.9 INC)
- WIDTH:
INTERIOR: 200 CM (78.7 INC)
EXTERIOR: 215 CM (84.6 INC)
- HEIGHT:
INTERIOR: 195 CM (76.8 INC)
EXTERIOR: 260 CM (102.4 INC)



Accommodates

Two individuals comfortably

Sleeping Arrangements

Convertible double bed located at the front, measuring 130cmx198cm

Kitchen

Spacious and functional kitchen area at the back, measuring 120cm x 50cm.

Bathroom

Convenient and well-appointed bathroom at the back, measuring 75cm x 100cm.

Chassis

The caravan utilizes a robust KNOTT chassis for enhanced stability and durability.



MONDE 375

CARAVAN DIMENSION

- BODY LENGTH: 375 CM (147.6 INC)
- OVERALL LENGTH: 530 CM (208.7 INC)
- WIDTH:
INTERIOR: 200 CM (78.7 INC)
EXTERIOR: 215 CM (84.6 INC)
- HEIGHT:
INTERIOR: 195 CM (76.8 INC)
EXTERIOR: 260 CM (102.4 INC)



Accommodates

Three or Four individuals comfortably

Sleeping Arrangements

Three individuals: Convertible double bed in the front, measuring 130cm x 198cm and a convertible single bed in the back, measuring 66cm x 198cm. Above the rear seating area, a convenient cupboard offers additional storage.

Four individuals: This variation replaces the rear cupboard with a bunk bed, increasing the sleeping capacity.

Kitchen & Bathroom

A well-equipped kitchen area occupies the right side, measuring 95cm x 50cm.

Convenient and well-appointed bathroom at the back, measuring 75cm x 100cm.

Chassis

The caravan utilizes a robust ALKO chassis for enhanced stability and durability.



MONDE 425

CARAVAN DIMENSION

- BODY LENGTH: 425 CM (167.3 INC)
- OVERALL LENGTH: 522 CM (205.5 INC)
- WIDTH:
INTERIOR: 200 CM (78.7 INC)
EXTERIOR: 215 CM (84.6 INC)
- HEIGHT:
INTERIOR: 195 CM (76.8 INC)
EXTERIOR: 260 CM (102.4 INC)



Accommodates

Three or Four individuals comfortably

Sleeping Arrangements

Three individuals: Convertible double bed in the front, measuring 145cm x 198cm and a convertible single bed in the back, measuring 85cm x 198cm. Above the rear seating area, a convenient cupboard offers additional storage.

Four individuals: This variation replaces the rear cupboard with a bunk bed, increasing the sleeping capacity.

Kitchen & Bathroom

A well-equipped kitchen area occupies the right side, measuring 120cm x 50cm.

Convenient and well-appointed bathroom at the back, measuring 80cm x 110cm.

Chassis

The caravan utilizes a robust ALKO chassis for enhanced stability and durability.





MONDE
DESIGN
CARAVAN

GET IN TOUCH



Odunluk Mah. Karsidag Sok.
No: 5 H/A No: 15
Nilüfer / Bursa /Turkey



+90 533 638 33 16



mondedesigncaravan



<https://www.mondecaravan.com>



info@mondecaravan.com